

Elipsa™ Litter Bin

OPERATOR AND MAINTENANCE INSTRUCTIONS

IMPORTANT NOTE: ENSURE THAT ALL RELEVANT PERSONNEL READ THESE INSTRUCTIONS PRIOR TO USE

We recommend that a risk assessment is undertaken to identify an appropriate location for your waste collection and recycling units.

Please also refer to the 'Manual Handling Operations Regulations 1992' during the handling of the product. Ensure that all relevant personnel read the points listed within this leaflet and that a copy is given to staff included with the installation and maintenance of this product.

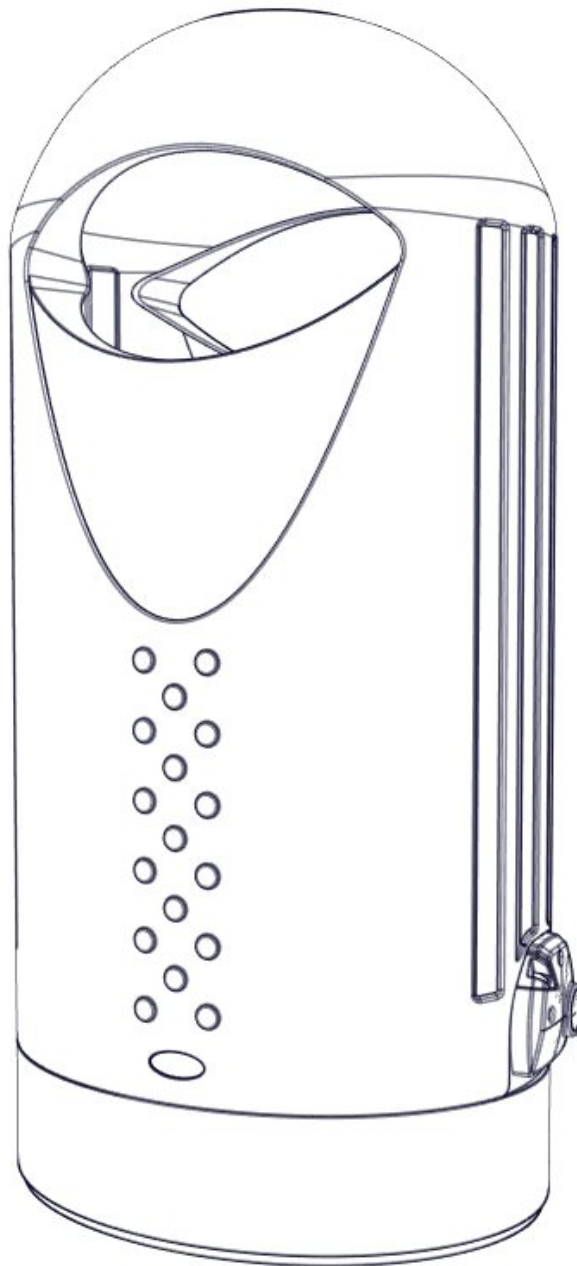

OPERATION

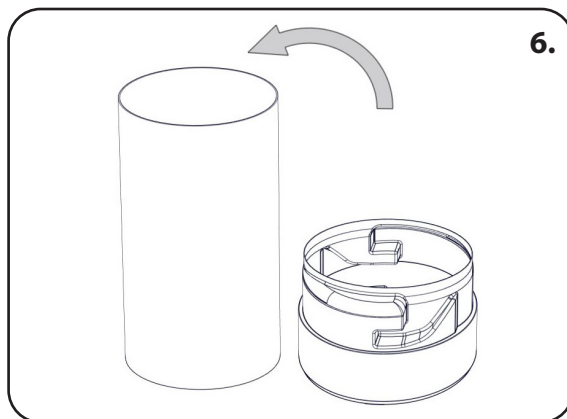
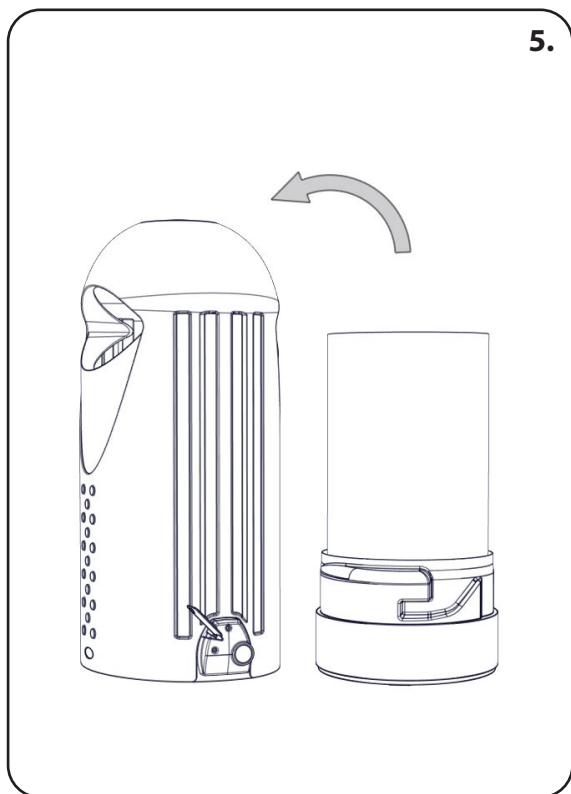
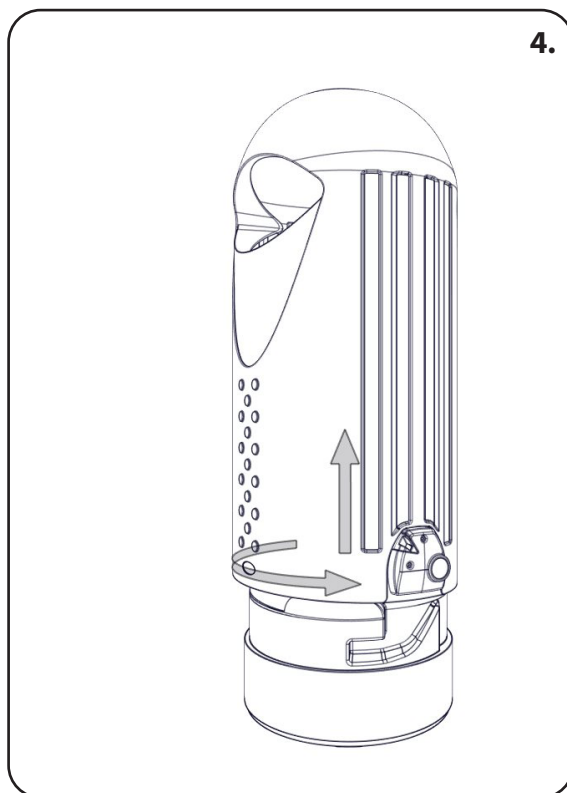
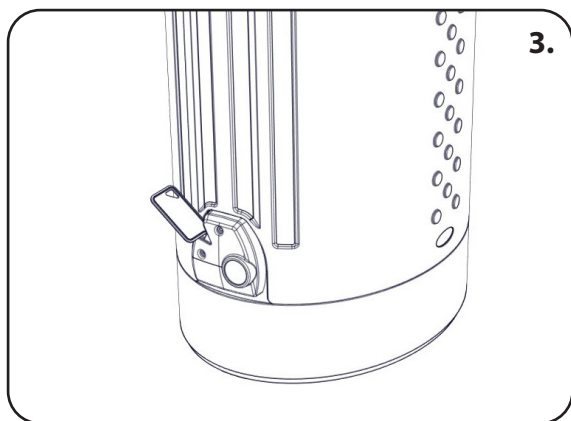
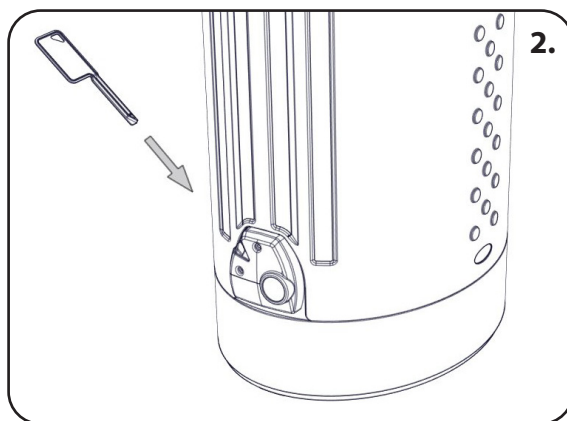
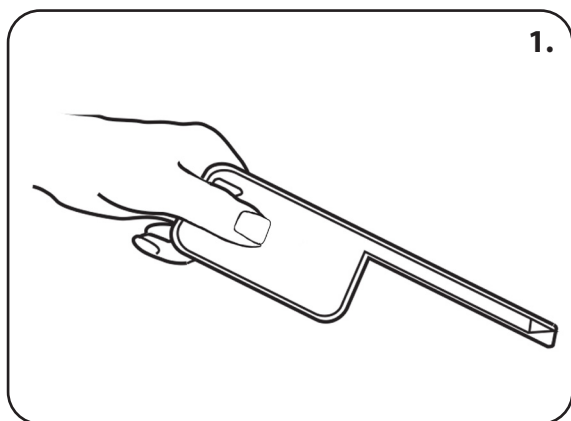

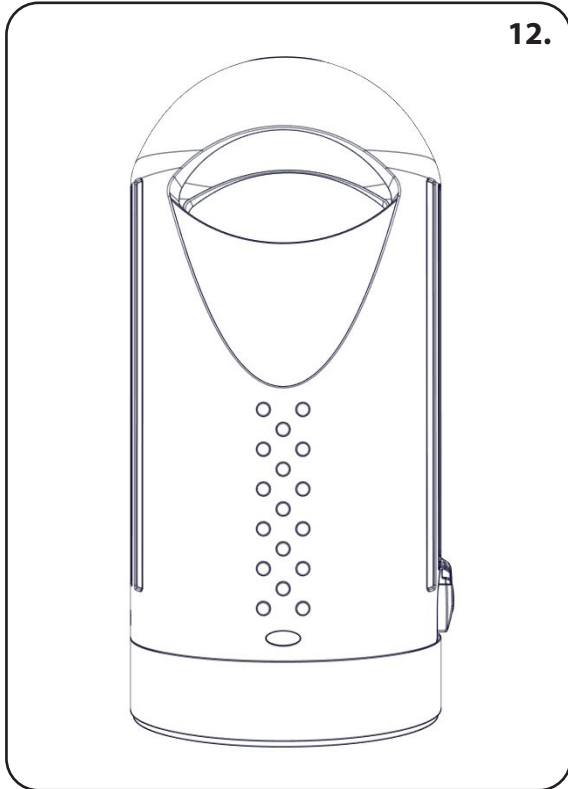
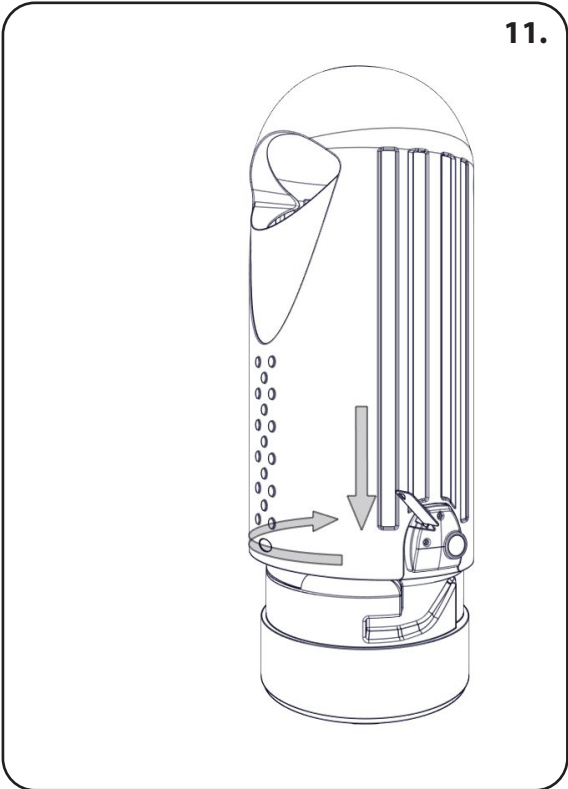
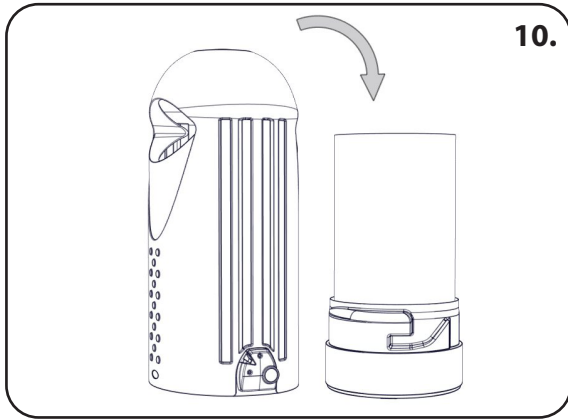
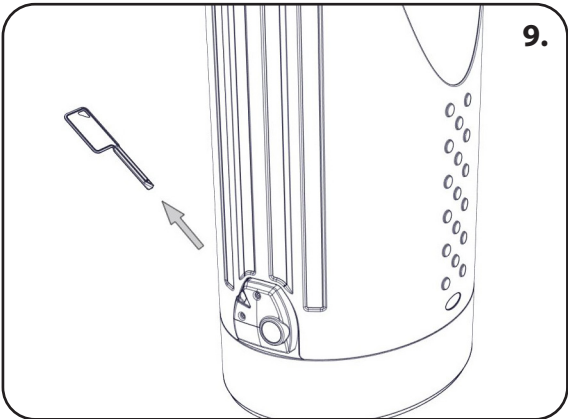
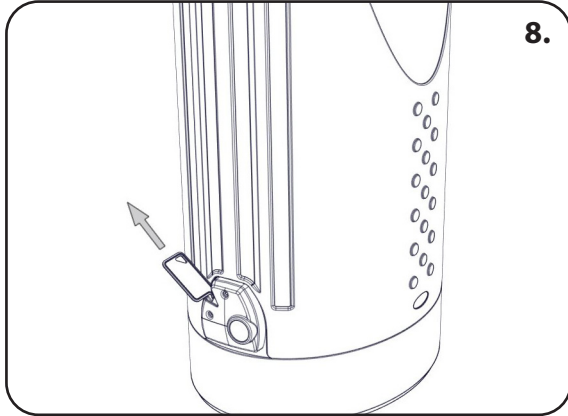
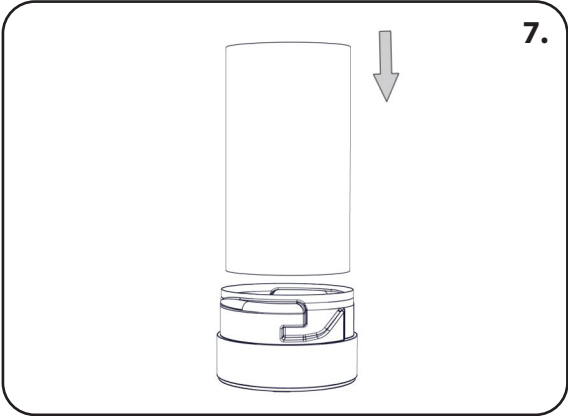

PRODUCT MAINTENANCE

CLEANING

We would recommend a warm pressure wash with soap or alternatively hand wash with 10% solution of mild detergent in warm water using a soft bristle brush followed by a rinse with clean water.

GRAFFITI

Felt tip pen or paint may be removed from the Armortec coated steel parts using a proprietary graffiti remover. Carefully follow the instructions, particularly the guidelines covering safety. Ensure that all traces of chemicals are removed then clean as detailed above.

MAINTENANCE

A planned maintenance schedule of regular inspection is recommended and components replaced when necessary.

IMPORTANT NOTE: PLEASE ENSURE THAT ALL RELEVANT PERSONNEL READ THE POINTS LISTED WITHIN THIS LEAFLET AND THAT A COPY IS GIVEN TO STAFF INVOLVED WITH THE INSTALLATION AND MAINTENANCE OF THIS PRODUCT
SAFETY NOTE: PLEASE REFER TO 'THE MANUAL HANDLING OPERATIONS REGULATIONS 1992' DURING HANDLING.



Glasdon AND ELPSA ARE TRADEMARKS OR IS REGISTERED TRADEMARKS OF GLASDON GROUP OR ITS SUBSIDIARIES IN THE U.K. AND OTHER COUNTRIES

- A planned maintenance schedule or regular inspection is recommended, replacing components as necessary.
- Replacement components are available direct from GLASDON.
- GLASDON cannot be held responsible for claims arising from incorrect installation, unauthorised modifications or misuse of the product.

Stock No. C000/0531- DWG No. 07B-377-41 Issue 1 - February 2020

© Copyright February 2020

Glasdon UK Ltd reserve the right to alter specifications without prior notice.



Glasdon[®]

Glasdon U.K. Limited
Preston New Road
BLACKPOOL
Lancashire
FY4 4UL

Tel: (01253) 600410
Fax: (01253) 792558
e-mail: sales@glasdon-uk.co.uk
web: www.glasdon.com